

US 1 Corridor Redevelopment (continued)

Median Landscaping

Medians will be landscaped along the length of the project

Sod

All median areas not receiving ground cover or shrubs will be fully sodded

Ground Cover/Shrubs

Used in smaller islands, accent points in larger islands, and in areas with sight restrictions

Small Trees

Spaced at 30-foot intervals in between specimen trees along longer stretches of medians

Specimen Palm Trees

Used in median areas without sight restrictions at intervals of approximately 150 feet

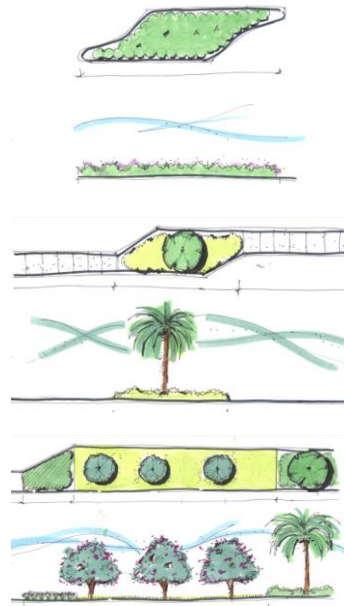

Aesthetic Lighting

Aesthetic lighting, provided within the City of Cocoa limits, and will consist of:

- Colored aluminum pole with decorative arm and decorative fixture
- Shorter poles in some locations to avoid FP&L pole and wire conflicts
- Traffic signal pole -mounted at some intersections
- The light poles on this project will be similar to those on the southern section of US 1; however, in order to meet current FDOT lighting standards, the majority of the light poles will be taller pole (45 feet tall instead of 35 feet), poles will be aluminum instead of concrete; and fixtures will be upgraded. To the left is an illustration of the light pole designed for this project.

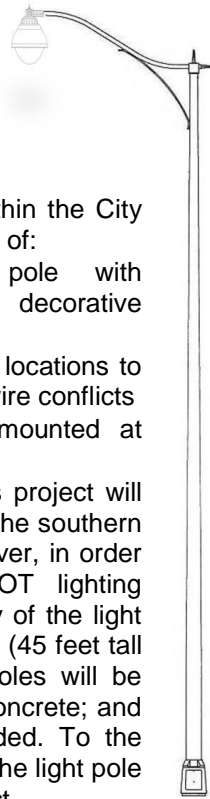

July 26, 2012

Brevard Central Library & Reference Ctr.
308 Forrest Avenue | Cocoa, FL 32922

Welcome to the Florida Department of Transportation (FDOT) public information meeting concerning the planned reconstruction of US 1 (SR 5) from north of Pine Street to north of Cidco Road in Brevard County. The project involves widening US 1 from four lanes to six lanes, constructing raised medians, curb and gutter improvements, traffic signals, lighting, landscaping, hardscaping, sidewalks, and bike lanes. It is currently in the design phase and design is scheduled for completion in late summer 2012. The project is currently funded for construction in the FDOT Five-Year Work Program, and has an anticipated construction start date in summer 2013.

US 1 (State Road (SR) 5) Public Information Meeting

US 1 (SR 5) Plans Update from Pine Street to Cidco Road | Brevard County
Financial Project ID Number: 237592-2-52-01



Project Location Map

Meeting Agenda

5:30 pm

Please Sign-in

Open House

6:00 pm

Presentation

Open House Question & Answer Session

7:30 pm

Meeting Concludes

Public Comments

Your input is very important during this process. We encourage you to learn more about the project and provide us with your comments or questions. Comment forms are available at the registration table. Please take this opportunity to complete a comment form. Comment forms received tonight or mailed, faxed, or e-mailed within ten (10) days will be included in the public record for this public meeting. A drop box is available for comment forms completed this evening. After this meeting, you may send your comments via e-mail, mail, or fax. Please feel free to ask FDOT staff and consultants questions after this presentation. Information about this project is also available online at www.cflroads.com. If you have questions or comments, please feel free to contact the FDOT Project Manager:

Ashraf Elmaghraby, PE - District 5 Consultant Project Manager

FDOT | 719 S. Woodland Blvd

DeLand, FL 32720

Phone (386) 943-5645

Fax (386) 943-5659

E-mail ashraf.elmaghraby@dot.myflorida.com

Nondiscrimination Statement

This meeting and project is being conducted without regard to race, color, national origin, age, sex, religion, disability or family status. Persons wishing to express their concerns relative to FDOT compliance with Title VI may do so by contacting the FDOT District Five Title VI Coordinator Gerallynn Morgan, 719 South Woodland Boulevard, Deland, Florida 32720 or the Florida Equal Opportunity Office, 605 Suwannee Street, Room 260, Mail Station 65, Tallahassee, FL 32399-0450. All inquiries or complaints will be handled according to FDOT procedure and in a prompt and courteous manner.



Project Description

The proposed US 1 six-lane typical section is illustrated below:

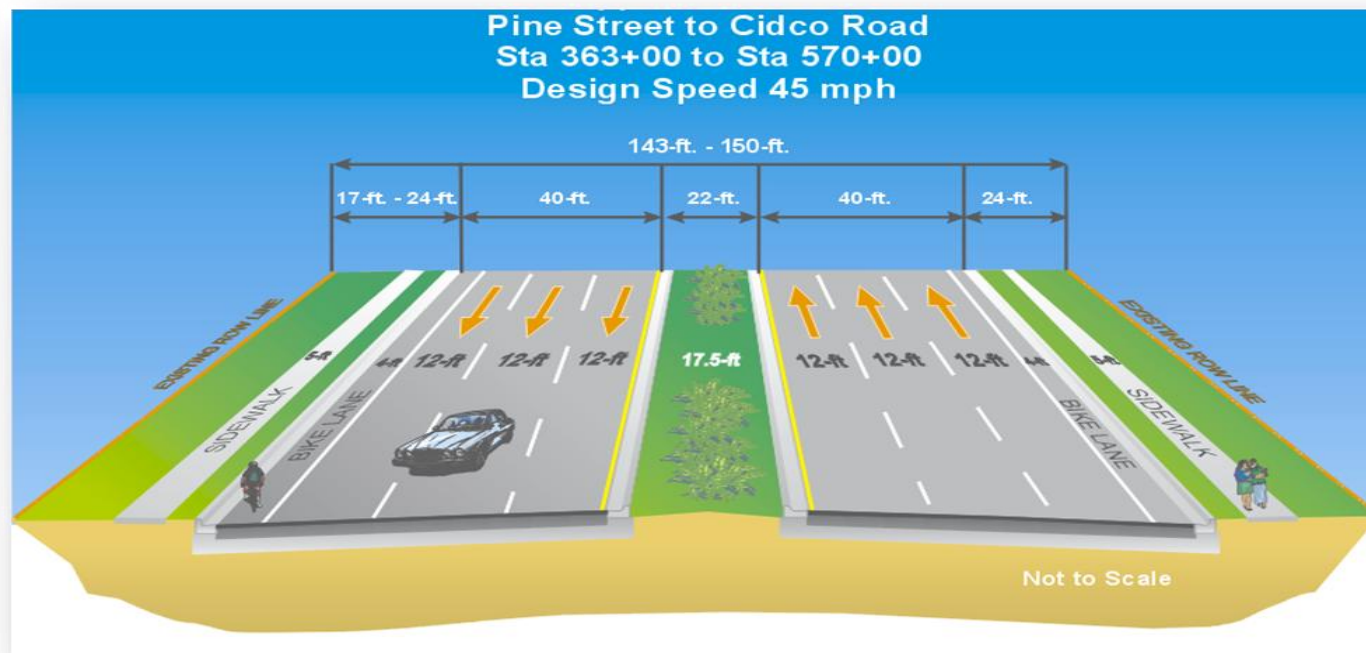

Traffic Signals

Traffic signals will be improved or replaced at the following locations within the limits of the project: Forrest Avenue, Dixon Boulevard, Michigan Avenue, and the SR 528 (Beachline Expressway) eastbound and westbound ramps.

Stormwater Management

Stormwater management will be provided through a closed storm drain system. City of Cocoa Regional Ponds will be utilized, and two new ponds will be constructed – one within the SR 520 interchange and another north of the city limits adjacent to US 1 on FDOT property. In addition, a floodplain pond will be constructed between Olive Street and Grimes Street.

Driveway Modifications

Modifications to driveways accessing US 1 were evaluated on a case-by-case basis. FDOT conducted driveway meetings during original design in July 2003, and again in July 2011 for plans update. Property owners were notified of a driveway modification if the width of a driveway(s) would change by more than four feet. The first notices to property owners were sent in late 2011, followed by a second notice with administrative hearing rights to any owners not completing a driveway agreement in Spring 2012. Numerous one-on-one driveway coordination meetings have taken place. If you have questions concerning modifications to your driveway, please feel free to ask an FDOT representative at tonight's meeting or contact: Ashraf Elmaghraby, PE - FDOT Consultant Project Manager, at (386) 943-5456 or e-mail ashraf.elmaghraby@dot.myflorida.com.

Traffic Control

FDOT will strive to minimize impacts to the public while maintaining safety during construction. The traffic control plans will ensure the following:

- Maintain two lanes in each direction on US 1
- Maintain access to properties along US 1
- Provide business access signage in the construction area
- Maintain access to bus stops along US 1
- Maintain bicycle and pedestrian access along US 1
- Minimize the use of temporary pavement

Access Management Reclassification

FDOT, in accordance with Florida Statute 335.188 and Administrative Rule 14-97, provided notification to modify the existing Access Management Classification for a segment of US 1 from Michigan Boulevard to Cidco Road, a distance of 1.546 miles, from Class 3 to Class 5 at the July 23, 2003 US 1 Widening Design Public Information Meeting.

This action has been justified based on projected future traffic volumes, increased urbanization and is consistent with the planned reconstruction of this facility. The re-classified segment will also be in conformance with the current classification of the adjacent section of US 1. Class 5 and Class 3 Access Management requirements are listed in the table to the right.

Class 3	Class 5
Minimum Side Street Connections (Speed Limit 45 mph or Less)	
440 feet	245 feet
Minimum Distance Between Directional Median Openings	
1,320 feet	660 feet
Spacing Between Full Median Openings (Speed Limit 45 mph or Less)	
2,640 feet	1,320 feet
Spacing Between Traffic Signals	
2,640 feet	1,320 feet

US 1 Corridor Redevelopment

The City of Cocoa Community Redevelopment Agency (CRA) is working with FDOT to develop plans for landscaping, aesthetic lighting, and other enhancements to US 1 within the city limits. The redevelopment goals for this corridor are to:

- Maintain a consistent look along the City of Cocoa's primary roadway corridors
- Beautify the US 1 corridor to promote economic growth in the City of Cocoa
- Take advantage of the redevelopment opportunity presented with FDOT's widening of US 1

This project involves several design elements related to community redevelopment. These include: Intersection enhancements at Forrest Avenue, Dixon Boulevard, Michigan Avenue, and the SR528 Interchange; median landscaping; aesthetic lighting; traffic signal enhancement; and traffic separator enhancement.

Intersection Enhancements

Forrest Avenue

- Trees and shrubbery in the northeast and southeast corners of the intersection, shrubbery in the intersection's directional median.
- Textured and colored concrete around the northeast and southeast corners of the intersection, and traffic separators north and south of the intersection
- Painted traffic signal mast arms

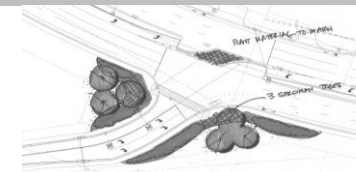

Dixon Boulevard

- Shrubby in the four corners of the intersection and in the median on the north side
- Textured and colored concrete in the directional islands, traffic separator south of the intersection, and the concrete sidewalks around the four corners of the intersection
- Painted traffic signal mast arms



Michigan Avenue

- Shrubby in the four corners of the intersection, and in the median on the north side, with a tree on all corners except the southwest corner
- Textured and colored concrete in the traffic separator south of the intersection
- Painted traffic signal mast arms

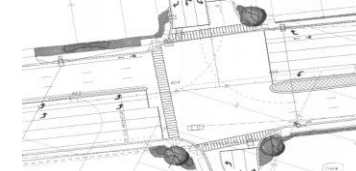

SR 528 Interchange

- Trees and shrubbery in the merge islands for the eastbound and westbound intersections, and in the median north of the overpass
- Textured and colored concrete traffic separators
- Painted traffic signal mast arms

